

property leasing & management

MIDTOWN WEST building details



Original facade

1050 MARIETTA STREET Suites A, B and C with Marietta Street exposure have been renovated into retail and/or office space. The complete adaptive redevelopment included new windows and doors, roof, electrical and HVAC systems, finished and sealed floors, restrooms, handicap access and landscaping.

As seen on the [4th location map](#), this building is located in a high profile location at the railroad bridge with the King Plow Arts Center located immediately to the west.

Suites A, B and C are 3,000sf, 1,840sf and 1,570 sf respectively and are all leased. The suites can be combined resulting in flexible square footage availability.

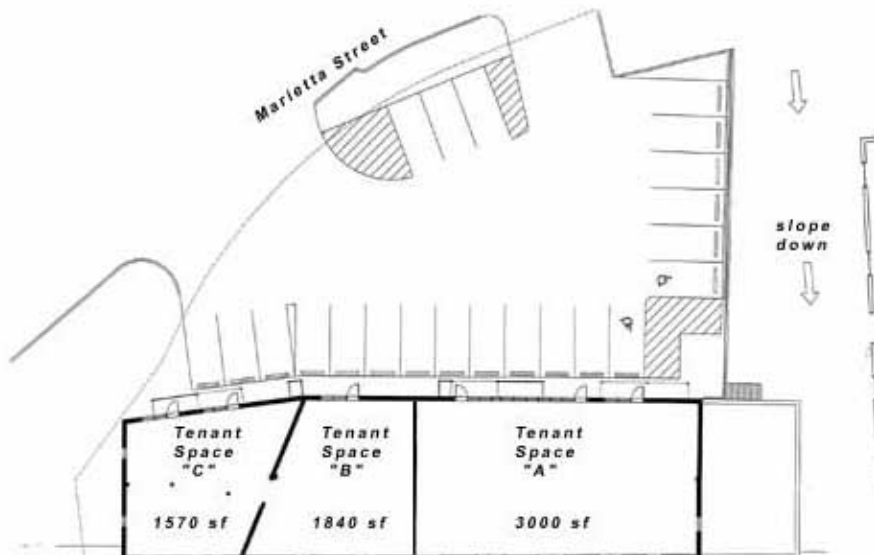

ABOVE: street level - suites A, B and C

For further information please contact:

Richard S. Martin

Midtown West Associates, LLC

V: 404-892-4267

F: 404-873-1730

e-mail: midtownwest@mindspring.com

website: www.midtownwest.com